

Ceta Canyon Camp Overview & Trails



CAMP MAP BROCHURE

Welcome to Ceta Canyon. We believe Ceta Canyon is a "special place where God is experienced & lives are changed". We pray that your stay with us is enjoyable & a blessing to you. If you have any questions about our facility or if you need help finding something for your group, feel free to contact us by visiting our office or using a call box to get hold of the 24 hour on-call staff.

Safety Guidelines:

- No swimming in the pond, creek, or waterfall.
- You may only swim in the pools when open.
- Be careful hiking. Stay off the cliffs.
- Keep away from wildlife & report problems to staff.
- Hike in groups of at least 3.
- The south rim, including the lighted cross on the Ceta side is private property. Please stay off
- Do not cross any fencing.
- Firearms, fire-works, alcoholic beverages, and the unlawful use of drugs are not allowed.
- Smoking is not allowed in any of the buildings.
- Pets, except for service animals, are not allowed.
- No rollerblades, skates, skateboards, bikes, etc.

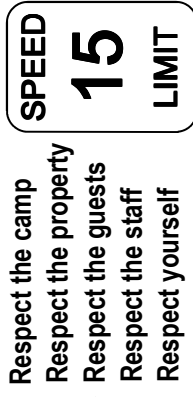

In Emergencies:

- Use a call box to contact Ceta Canyon Staff.
- For emergency requiring EMS, call 806-764-3535 for the Wayside EMS, (about 8 miles away).
- Need a physician; BSA Urgent Care Center, 4510 Bell St, Amarillo, TX 806-212-4835 –destination time =35 min

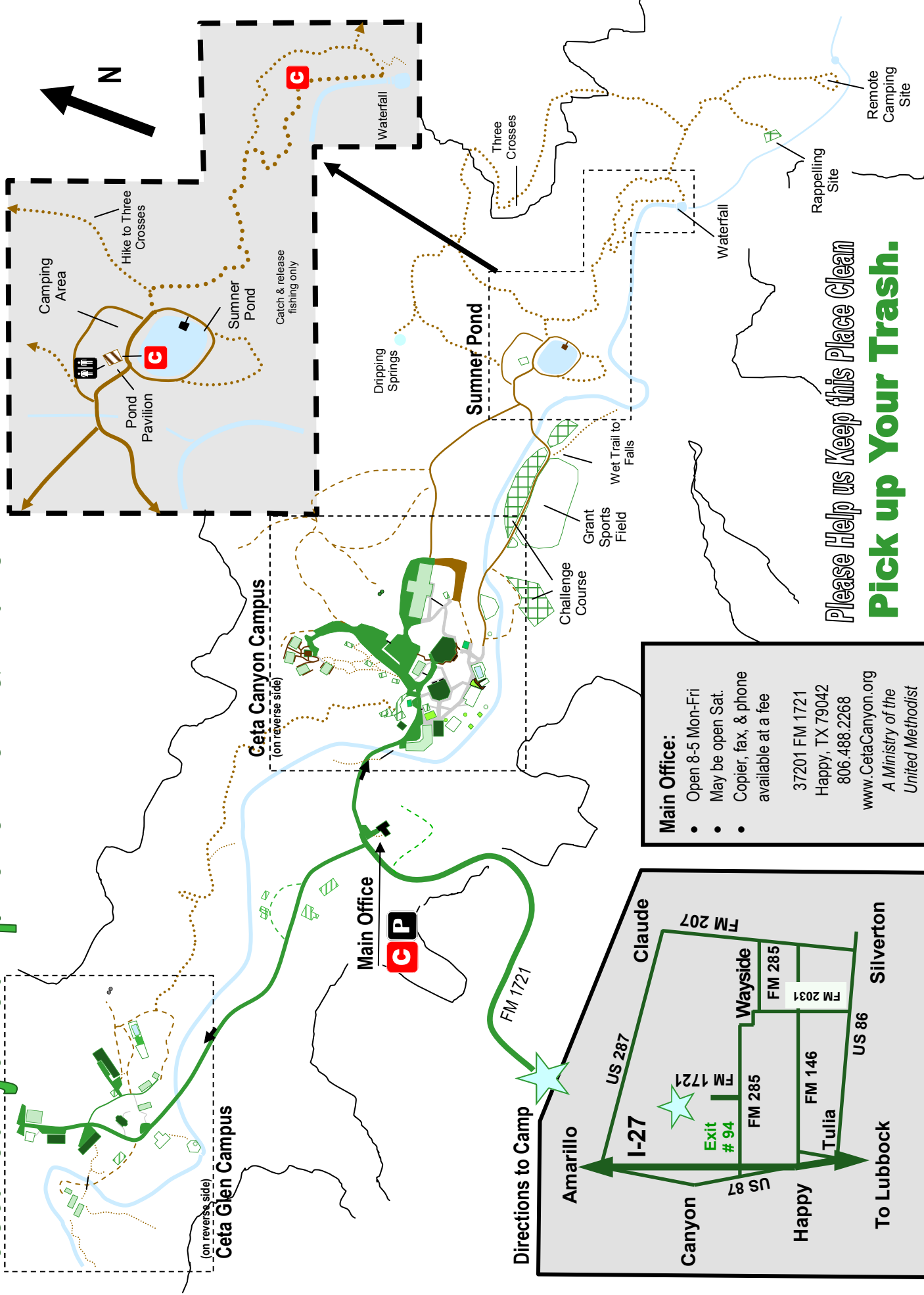

Please Help us Keep this Place Clean.
Pick up Your Trash.

Main Office:

- Open 8-5 Mon-Fri
 - May be open Sat.
 - Copier, fax, & phone available at a fee
- 37201 FM 1721
 Happy, TX 79042
 806.488.2268
www.CetaCanyon.org
 A Ministry of the United Methodist

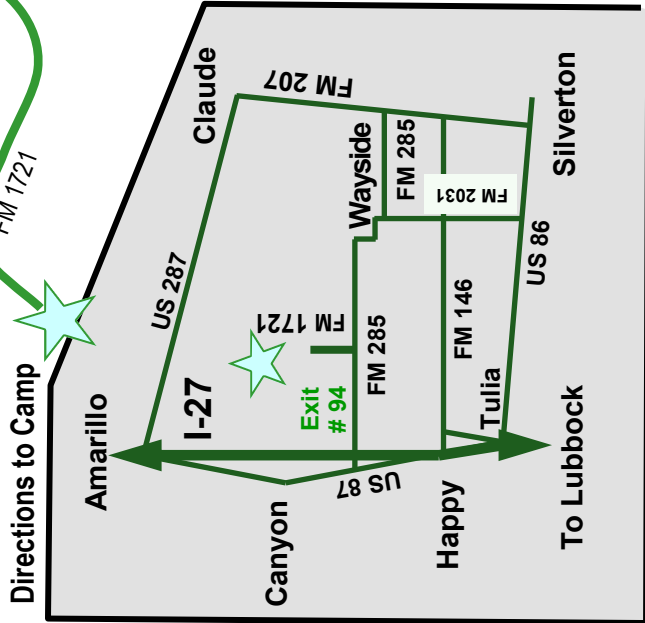

Ceta Canyon Campus

Ceta Canyon Camp has been around since 1918 serving Summer Camps with the United Methodist Church. Most of the camp's facilities have changed now & we look forward to serving our guests through providing comfortable sleeping facilities, meeting rooms, & recreational opportunities. Feel free to take a hike to our waterfalls, explore our 400 acres, fish in our pond (catch & release), or play football, soccer, or ultimate frisbee on our sports field.

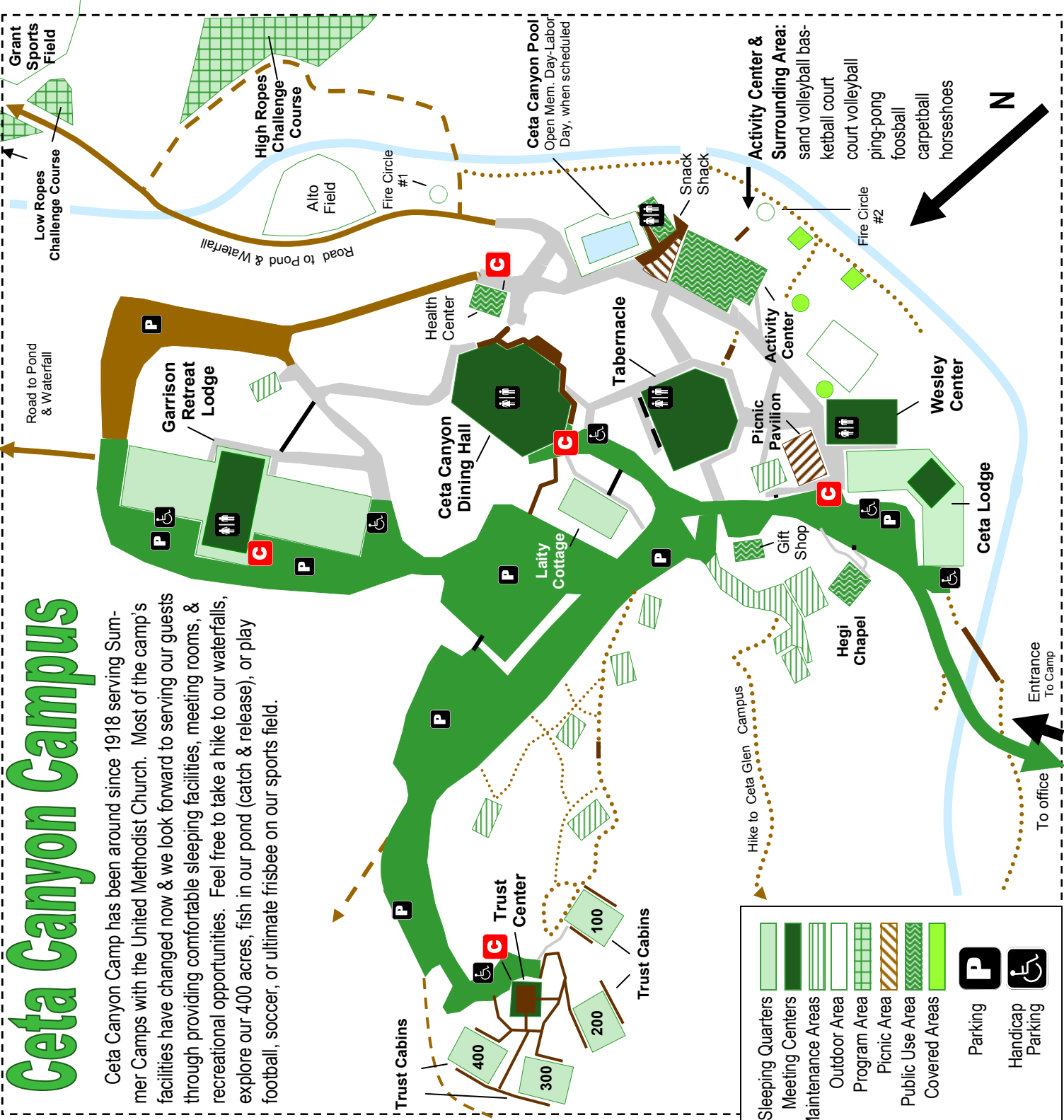

Ceta Glen Campus

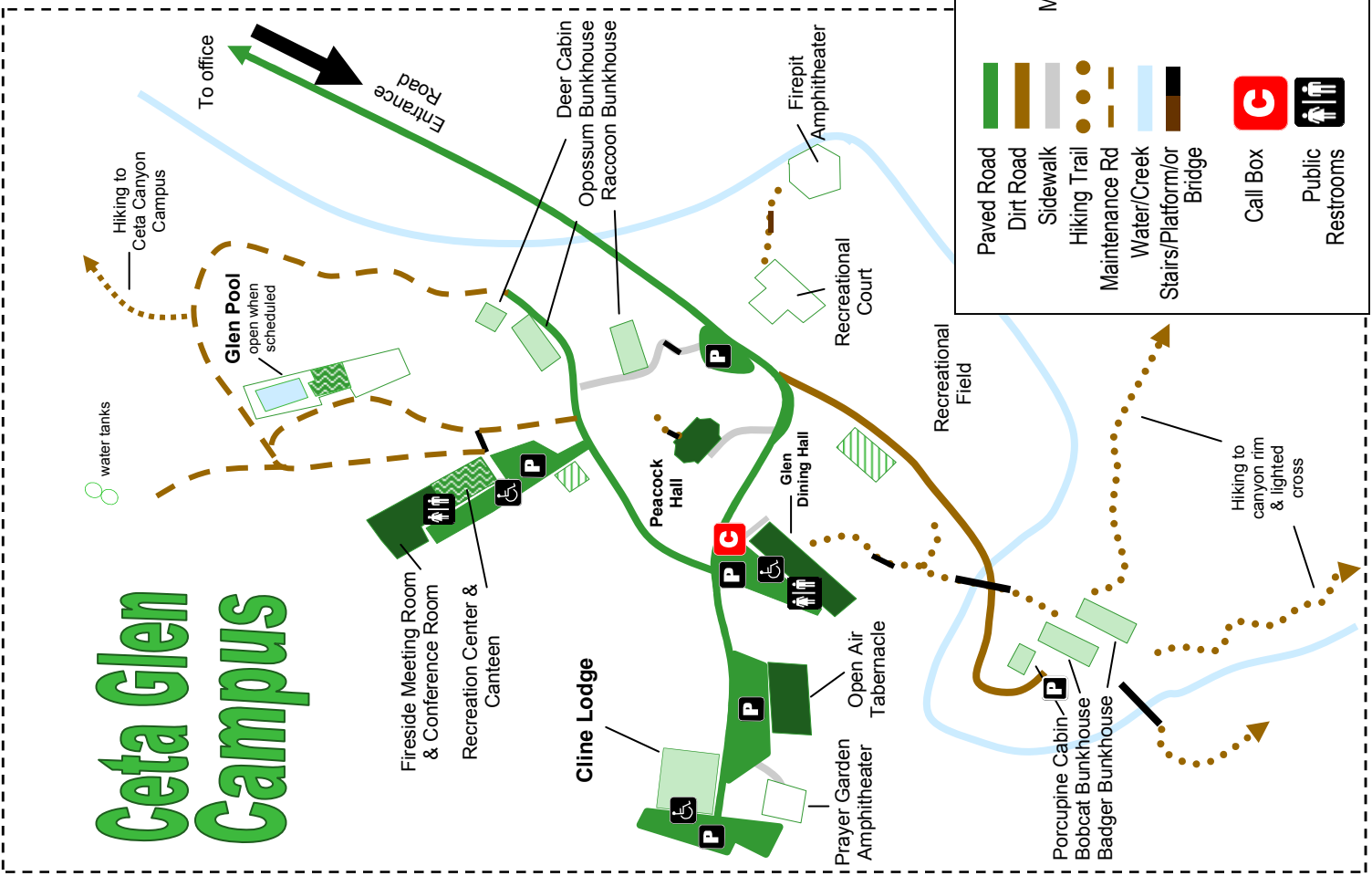

	Sleeping Quarters		Meeting Centers		Call Box
	Maintenance Areas		Outdoor Area		Parking
	Program Area		Picnic Area		Handicap Parking
	Public Use Area		Covered Areas		Public Restrooms
	Paved Road		Dirt Road		Hiking Trail
	Sidewalk		Maintenance Rd		Water/Creek
	Hiking Trail		Stairs/Platform/or Bridge		Recreational Field